

Foamer Simpson

Pump-Up Foamer Diagram

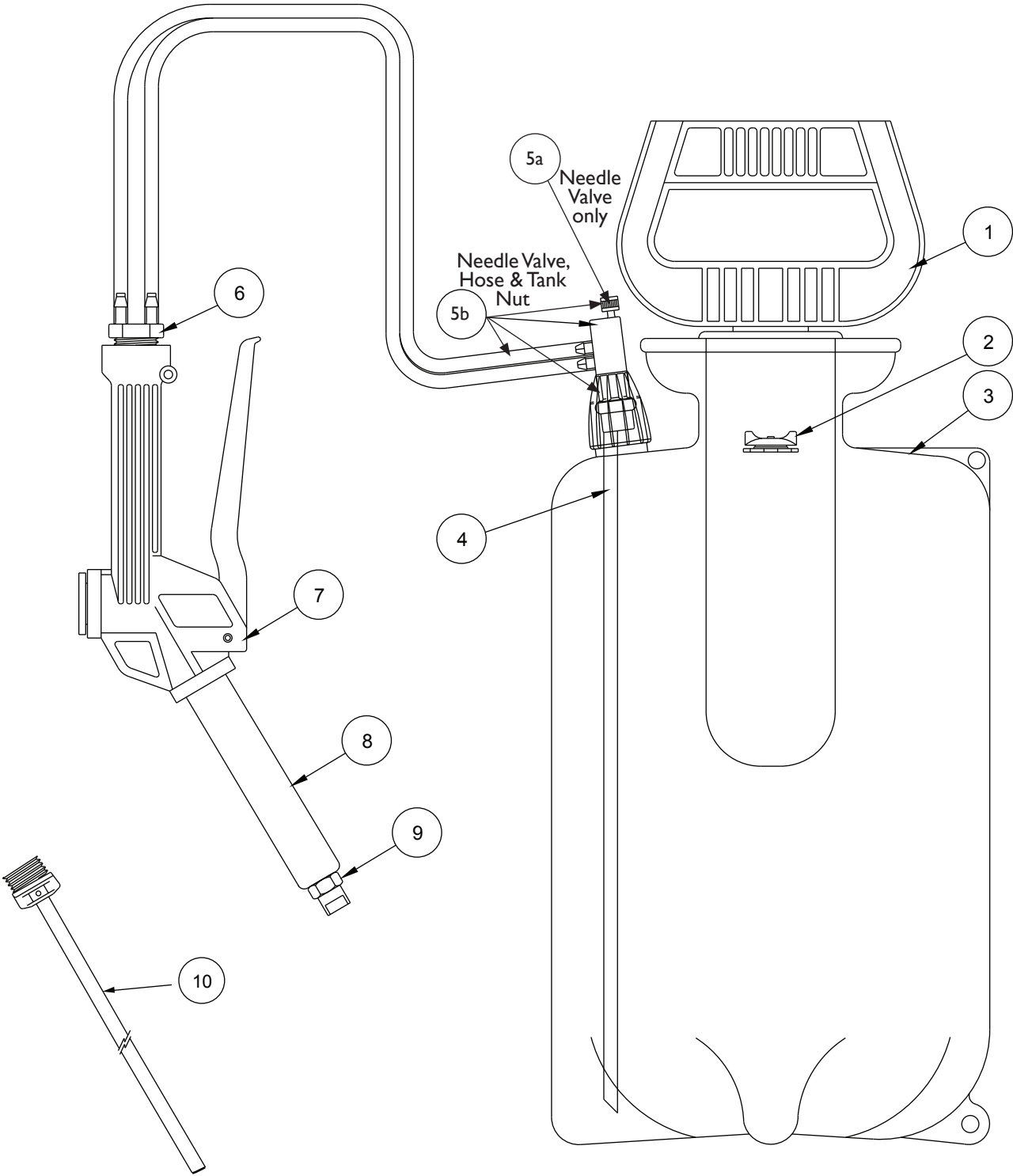

Warning

- ALWAYS wear proper protective clothing and goggles when dealing with chemicals.
- NEVER point discharge spray toward anyone.
- DEPRESSURIZE unit after use.

Instructions

1. Unscrew the pump assembly (item #1) from the tank (item #3).
2. Fill the tank about 1/2 full with the proper mixture of water and foaming chemical.
3. Screw the pump assembly back into the tank.
4. Twist the pump handle 1/3 of a turn counterclockwise and pump the handle.
5. Grasp the trigger gun (item #7) in hand, aim and squeeze the trigger.
6. Adjust foam consistency by turning the needle valve knob (item #5). Turning it counterclockwise will produce a dryer foam, while turning it clockwise will produce a wetter foam.
7. After use, before emptying or filling, remove all pressure from the unit by pulling up on the pressure relief valve (item #2).

Note: Silicone lubricant should be used to lube pump O ring. Do not use oil or mineral spirits, this will damage the O ring.

Item	Description
1	Black Viton Pump Assembly
2	Pressure Relief Valve
3	2 Gallon Tank
4	Pick-Up Tube
5a	Needle Valve Only
5b	Needle Valve Assembly w/Tank Nut, O Ring & Tubing
6	Double Hose Barb x 1/2" MPT
7	Poly Spray Gun 1/2" FPT, O Rings for PSG I2
8	Foam Mixing Material, 4" Poly Wand
9	S.S. Spray Tip 65°
10	Poly Extension Wand for FI-2